

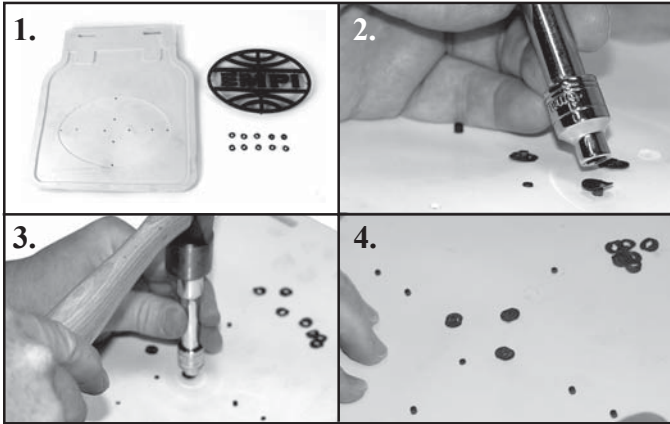

### Installation Instruction for EMPI Mud Flap

1. Place the EMPI logo into the recessed area of the mud flap.
2. Turn over and place it on a flat solid surface.
3. Apply pressure around each tab making sure that it is protruding through the mud flap adequately.
4. Start the lock plate (locking washer) onto the tab with the dish facing up, using a hammer and a small socket or similar tool, pound the lock plate down over the tab, anchoring the logo to the mud flap.



99-4320/0406



### Installation Instruction for EMPI Mud Flap

1. Place the EMPI logo into the recessed area of the mud flap.
2. Turn over and place it on a flat solid surface.
3. Apply pressure around each tab making sure that it is protruding through the mud flap adequately.
4. Start the lock plate (locking washer) onto the tab with the dish facing up, using a hammer and a small socket or similar tool, pound the lock plate down over the tab, anchoring the logo to the mud flap.

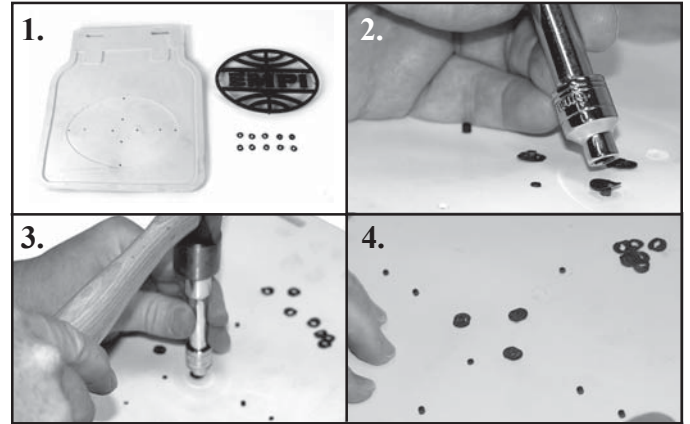

99-4320/0406



### Installation Instruction for EMPI Mud Flap

1. Place the EMPI logo into the recessed area of the mud flap.
2. Turn over and place it on a flat solid surface.
3. Apply pressure around each tab making sure that it is protruding through the mud flap adequately.
4. Start the lock plate (locking washer) onto the tab with the dish facing up, using a hammer and a small socket or similar tool, pound the lock plate down over the tab, anchoring the logo to the mud flap.

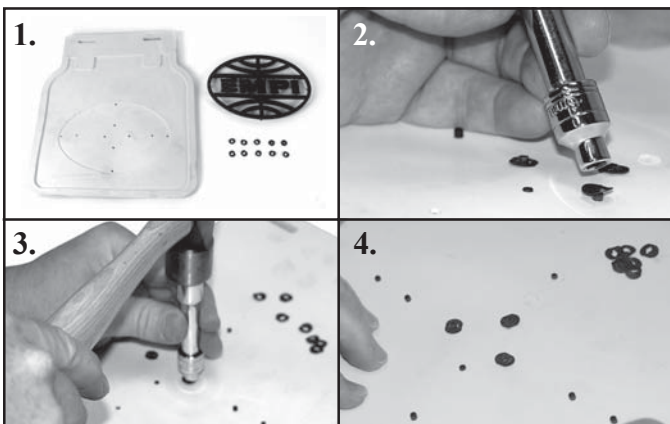

99-4320/0406



### Installation Instruction for EMPI Mud Flap

1. Place the EMPI logo into the recessed area of the mud flap.
2. Turn over and place it on a flat solid surface.
3. Apply pressure around each tab making sure that it is protruding through the mud flap adequately.
4. Start the lock plate (locking washer) onto the tab with the dish facing up, using a hammer and a small socket or similar tool, pound the lock plate down over the tab, anchoring the logo to the mud flap.

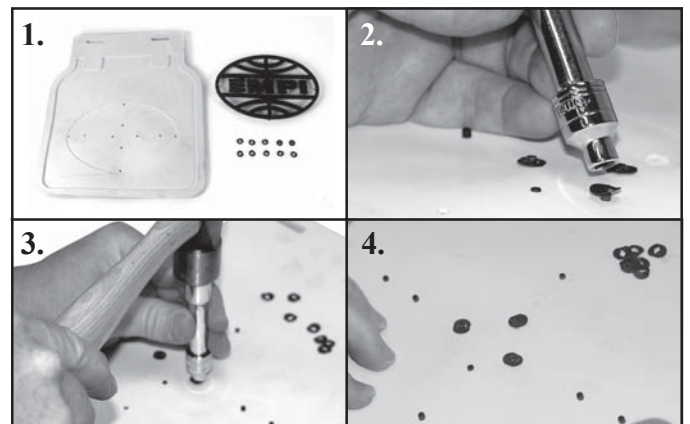

99-4320/0406