

40 & 42 DCNF

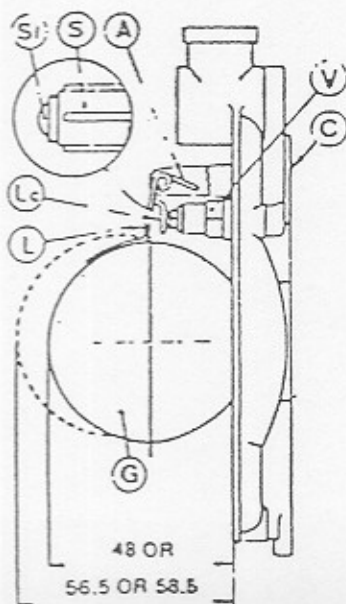
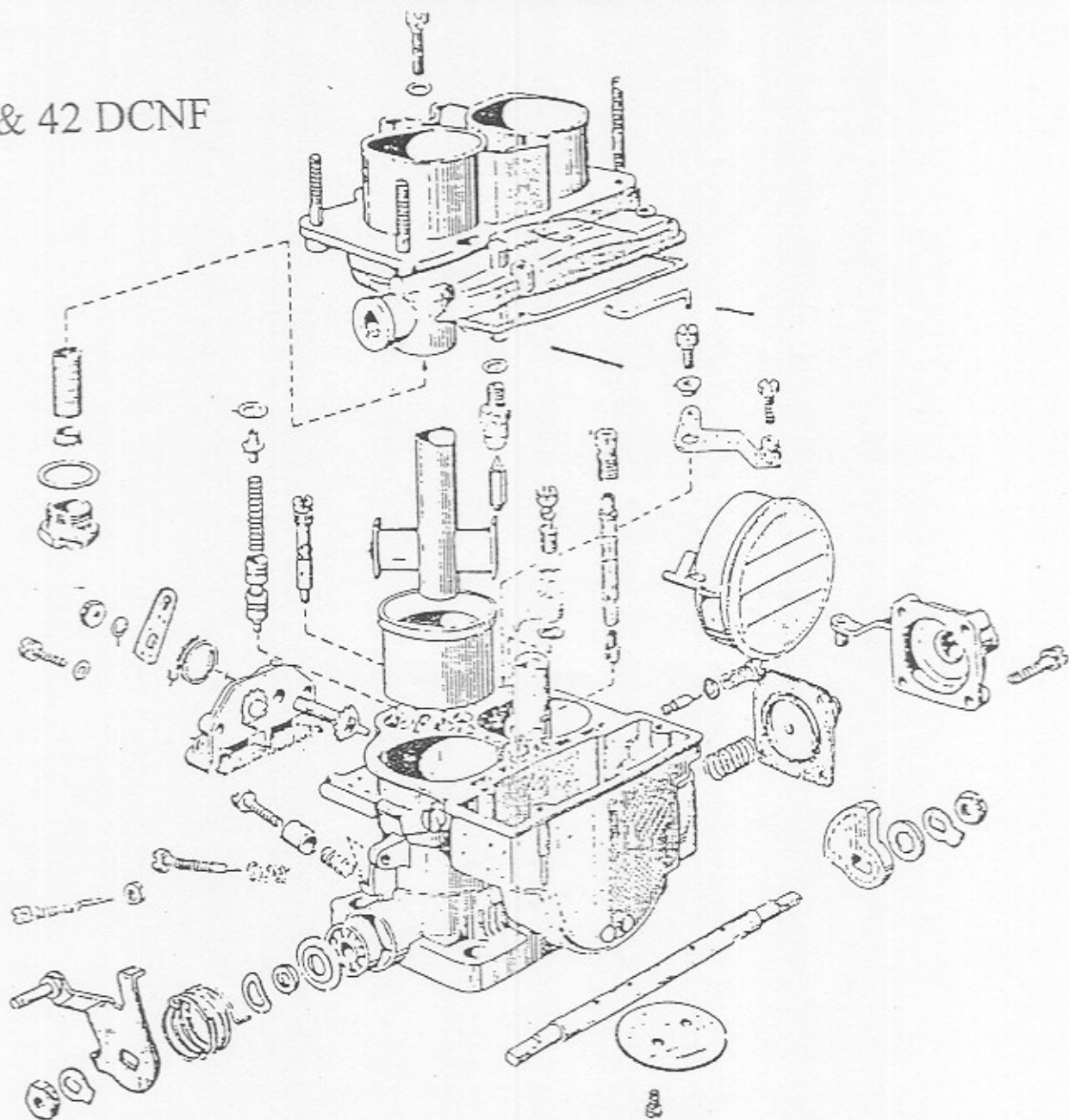

1. Setting of the float level should be carried out whenever it is necessary to replace either the float (G) or the needle and seat (S and V). In the latter case it is also desirable to replace the needle and seat gaskets.
2. Make certain that the float (G) can pivot freely on its axis and that the float tongue (LC) does not show any pitting or other signs of wear.
3. Check that the needle valve (V) is screwed tightly into the carburetor top cover (C) and that the spring-loaded ball (SF) is not jammed.
4. Keep the carburetor top cover (C) vertical as shown on the accompanying illustration, making certain the float tongue (LC) makes light contact with the spring-loaded ball (SF) without exerting any undue force that might compress the spring inside.
5. Using Weber float gauge no. 98026.100 for 40 DCNF 12 and 98027.700 for 42 DCNF 9, check that the distance from the carburetor top cover (C), without the top cover gasket in place to the float (G) 50mm for 40 DCNF 12 and 48mm for DCNF 9. If necessary remove the float (G) and carefully adjust the position of the tongue (L) with a pair of needle nose pliers to the effect the correct dimensions.
6. After the float level has been set, check that the travel of the float (G) is 8.5mm. If necessary this may be adjusted to the correct dimension by removing the float (G) and carefully bending tab (A) with a pair of needle nose pliers.
7. Fit the carburetor top cover (C) to the carburetor while insuring that the float (G) can move freely without any hindrance or friction.